



# Welcome

Admission is free. Donations are accepted.

**HARN MUSEUM OF ART**  
UNIVERSITY OF FLORIDA

## MUSEUM ETIQUETTE

- Thank you for not touching the art and display cases.
- Please silence cell phones while in the galleries.
- Food, beverages and gum are not allowed in the galleries.
- Please check umbrellas and large bags in at the Security Desk.
- Non-flash photography for personal use is permitted except where noted in the galleries.

## INFORMATION DESK

Have a question? Stop here and pickup materials on exhibitions, programs, membership and rentals.

## CAMELLIA COURT CAFÉ

Located on the lower level of the Contemporary Gallery. Open Tuesday through Saturday, 11 a.m. – 2 p.m.

## TOURS

Saturdays and Sundays at 2 p.m.

**The Harn is committed to making its building, exhibitions, programs and services accessible for all audiences.**

## NAMED GALLERY SPACES

- A:** Eloise R. and William H. Chandler Auditorium  
**B:** Rick and Aase Thompson North Galleria  
**C:** Bishop Study Center  
**D:** Dorothy and E. Robert Langley Foyer  
**E:** S.F.I. Rotunda in honor of Haskell Hess  
**F:** Vam Cardwell York and E.T. York, Jr. Foyer  
**G:** James G. and Caroline Julier Richardson Gallery  
**H:** Gladys Gracy Harn Exhibition Hall  
**I:** Paula and Marshall Criser Garden  
**J:** Julia C. and Budd H. Bishop Gallery  
**K:** Harn Grandchildren Foyer

- L:** Given by Robert H. in Memory of Kathleen M. Axline  
**M:** S.F.I. Gallery in honor of Chauncey Stillman  
**N:** Irving J. Goffman Garden  
**O:** Melvin and Lorna Rubin Gallery  
**P:** William Pullen Hadley Foyer  
**Q:** Deirdre Downes Fogler Promenade  
**R:** Bob & Nancy Magoon Garden in Honor of Sam & Bessie Proctor  
**S:** S.F.I. Exhibition Hall in Honor of Avery Myles

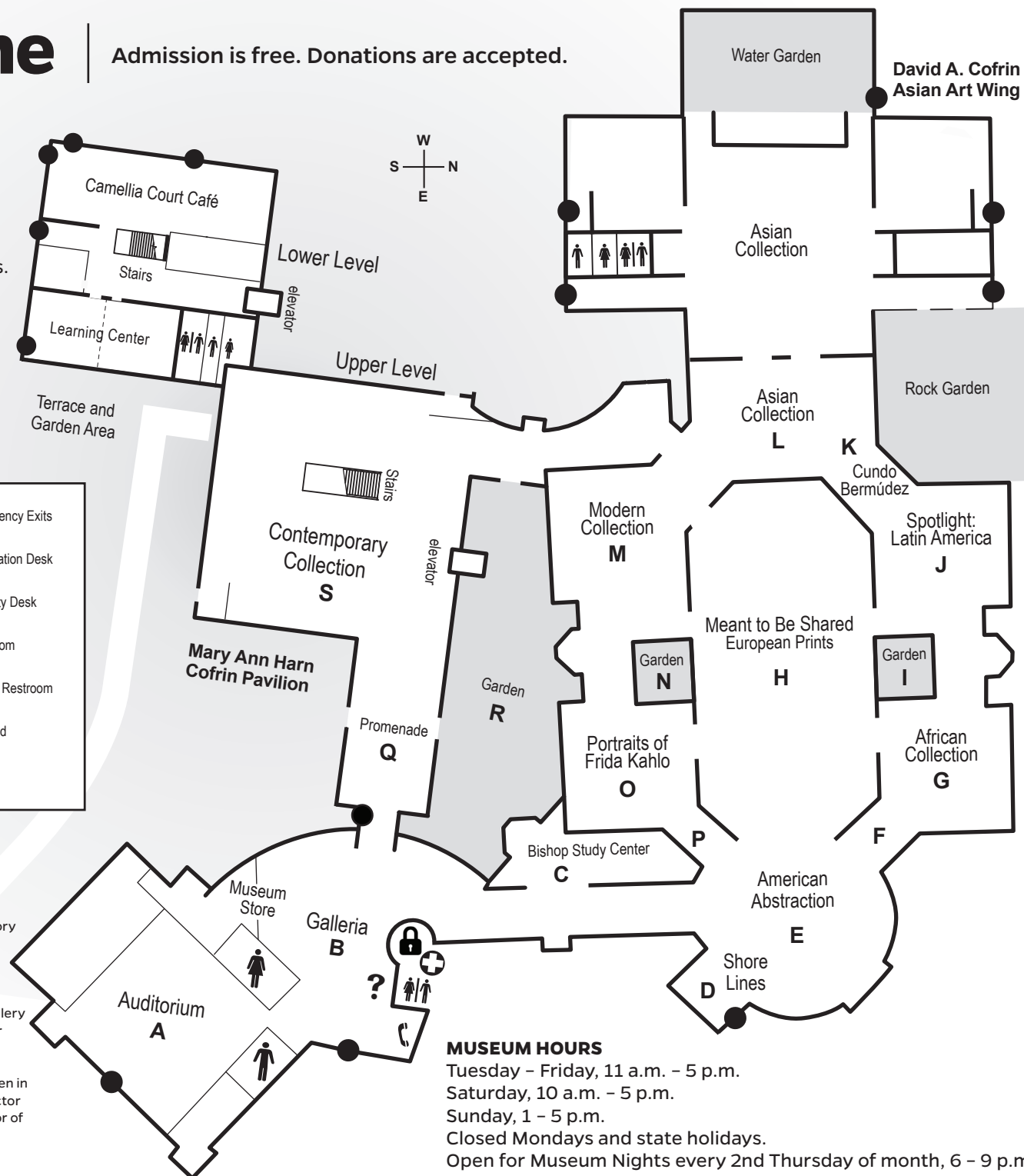
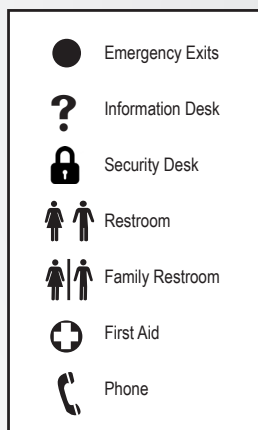

## MUSEUM HOURS

Tuesday – Friday, 11 a.m. – 5 p.m.  
 Saturday, 10 a.m. – 5 p.m.  
 Sunday, 1 – 5 p.m.  
 Closed Mondays and state holidays.  
 Open for Museum Nights every 2nd Thursday of month, 6 – 9 p.m.